

SHIP SPECIFICATIONS & FACILITIES

- 1,258 Guests
- 55,451 Gross Tons
- 720 Feet Long
- Automatic Stabilizers
- 10 Guest Decks
- 8 Guest Elevators
- 15 Public Rooms
- 3 Restaurants
- 2 Outdoor Swimming Pools (one with sliding glass roof)
- Health Spa
- Movie Theatre
- Duty-free Shops
- Library
- Casino
- Internet Center

VERANDAH DECK
Staterooms 100-220
156 ft. from bow
to Staterooms 100 & 102.

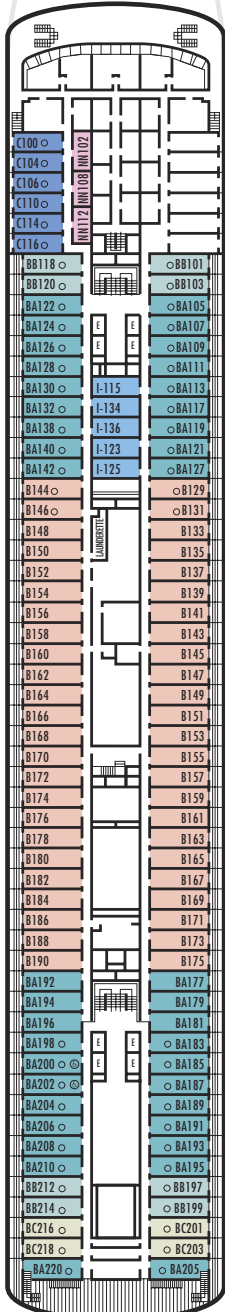

30 ft. to stern
from Staterooms 205 & 220.

NAVIGATION DECK
Staterooms 001-065
205 ft. from bow
to Staterooms 001 & 002.

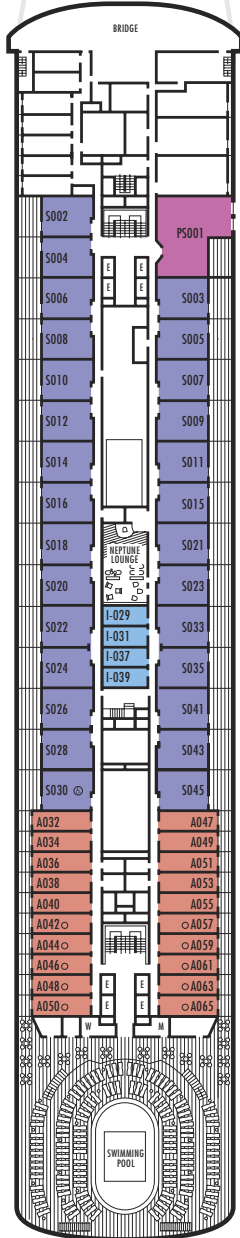

112 ft. to stern
from Staterooms 050 & 065.

LIDO DECK

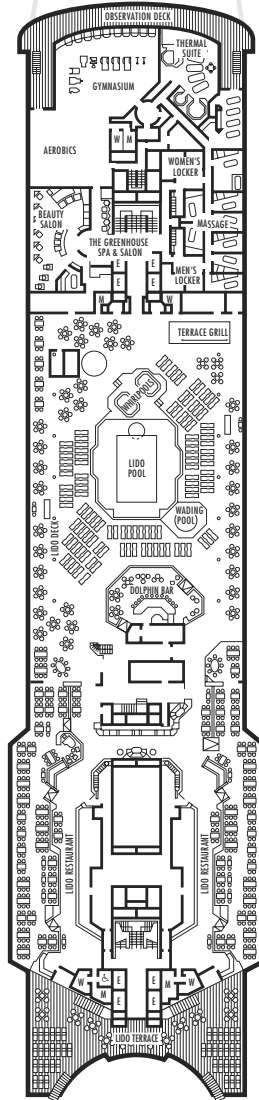

SPORTS DECK

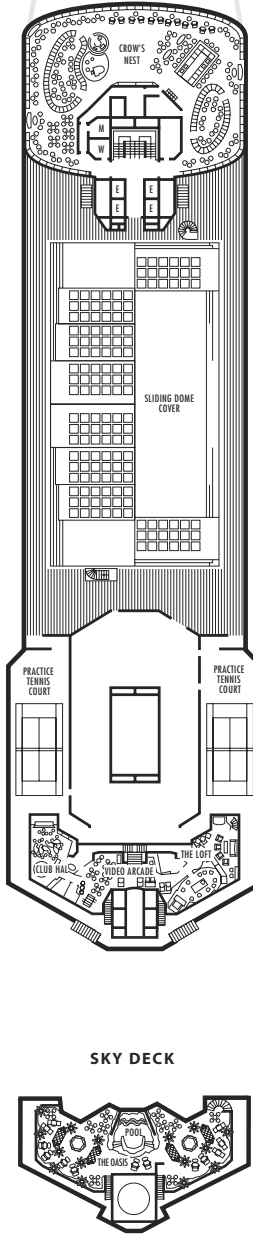

SKY DECK

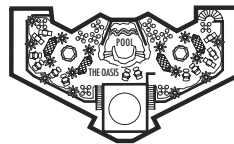

ms Statendam

DECK PLANS & STATEROOMS

The deck plans are color-coded by category of stateroom, and the category letter precedes the stateroom number in each room. All staterooms are equipped with DVD player*, television, telephone and multi-channel music.

Important Note: Not all staterooms within each category have the same furniture configuration and/or facilities. Appropriate symbols within the rooms on the deck plans describe differences from the stateroom descriptions below.

VERANDAH SUITES

PS
Penthouse Verandah Suite: Bedroom with 1 king-size bed, oversize whirlpool bath & shower, living room, dining room, dressing room, private verandah, pantry, 1 sofa bed for 2 persons, mini-bar, refrigerator, guest toilet, floor-to-ceiling windows.

S
Deluxe Verandah Suites: 2 lower beds convertible to 1 king-size bed, whirlpool bath & shower, large sitting area, dressing room, private verandah, 1 sofa bed for 2 persons, mini-bar, refrigerator, floor-to-ceiling windows.

A B BA BB BC
Verandah Suites: 2 lower beds convertible to 1 queen-size bed, whirlpool bath & shower, sitting area, private verandah, mini-bar, refrigerator, floor-to-ceiling windows.

OUTSIDE STATEROOMS

C D DA DD E EE
F FF G H
Large: 2 lower beds convertible to 1 queen-size bed, bathtub & shower. All DD-category staterooms have partial sea views.

HH
Large: 2 lower beds convertible to 1 queen-size bed, bathtub & shower. All HH-category staterooms have fully obstructed views.

INSIDE STATEROOMS

I J K L M MM
Large: 2 lower beds convertible to 1 queen-size bed, shower.
N NN
Standard: 2 lower beds convertible to 1 queen-size bed, shower.

*DVD players will be available in all staterooms after May 13, 2005. Currently, categories PS-BC have VCRs. All other categories are equipped with televisions only.

Culinary Arts Center, Explorations Café, The Oasis & The Loft will be completed May 13, 2005.

For sailings prior to Holiday 2005 please see the Holland America website at www.hollandamerica.com for stateroom category information.

STATEROOM SYMBOL LEGEND

- * Shower only
- Bathtub & shower
- Triple (2 lower beds, 1 sofa bed)
- Quad (2 lower beds, 1 sofa bed, 1 upper)
- △ Partial sea view
- × Fully obstructed view

Ⓢ The ms Statendam will be modified with the following features after May 13, 2005: Staterooms H501, H502, L500, D563, FF829, FF831, BA200, BA202, S030 are modified wheelchair accessible, shower only with small step, step into bathroom, ramp to verandah where applicable, standard interior and exterior door size.

♿ Staterooms C389, C390, H704, H706, H709 & H711 are wheelchair accessible, roll-in shower only, wheelchair accessible doorways.

